

SURVEY AND LOT SPLIT FOR LAWRENCE M. POLITZER JUNE, 2004

SITUATED IN THE TOWNSHIP OF TROY, COUNTY OF CEAUGA,
STATE OF OHIO
AND KNOWN AS BEING PART OF ORIGINAL SECTION 12
WITHIN SAID TOWNSHIP

PARCEL No. 32-053400
LAWRENCE MAX & CATHERINE ANN POLITZER, TRUSTEES
V. 1629, P. 561

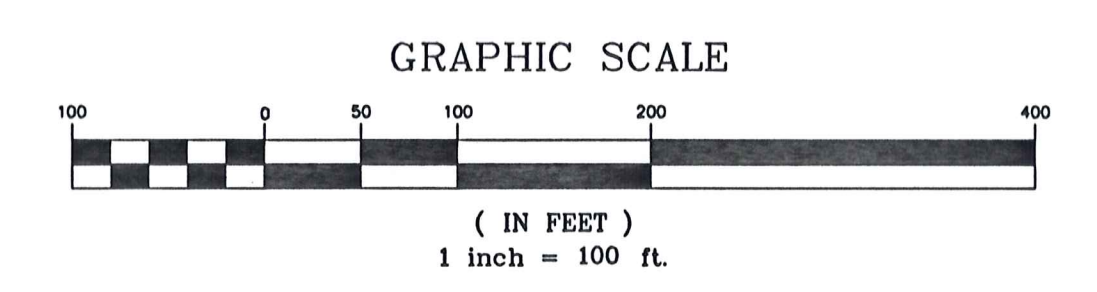
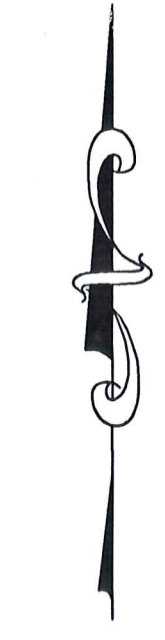

⊙ = 3/4" I PIN SET WITH "GUTOSKEY PS 7567" CAP
○ = 5/8" IRON PIN FOUND CAPPED "GUTOSKEY" UNLESS OTHERWISE NOTED
OBS = OBSERVED
REC. & MSD. = RECORD & MEASURED
(JNF) = PER BOUNDARY SURVEY COMPLETED IN
JANUARY OF 1997 BY JOHN N. FRANCIS,
PROFESSIONAL SURVEYOR S-6816
(AKRON) = PER BOUNDARY SURVEY INFORMATION
PROVIDED BY THE CITY OF AKRON ENGINEERING
SECTION.
P.O.B. = PLACE OF BEGINNING
P.P.O.B. = PRINCIPAL PLACE OF BEGINNING
NOTE: SURVEY IS BASED ON A LOT SPLIT SURVEY DATED MAY OF 2003,
COMPLETED BY GUTOSKEY & ASSOCIATES.

I HEREBY CERTIFY THAT I HAVE SURVEYED THE PREMISES AND PREPARED
THIS MAP IN ACCORDANCE WITH THE PROVISIONS OF CHAPTER 4733-37 OF
THE OHIO ADMINISTRATIVE CODE. DIMENSIONS ARE EXPRESSED IN FEET AND
DECIMAL PARTS THEREOF. BEARINGS ARE BASED ON A SURVEY BY THE CITY
OF AKRON, ALL OF WHICH I DECLARE TO BE CORRECT TO THE BEST OF MY
KNOWLEDGE.

Joseph Gutoskey
JOSEPH GUTOSKEY, P.S. No. 7567 DATE

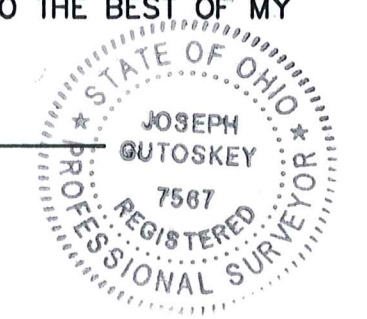

SURVEY PLAT & LEGAL DESCRIPTION
APPROVED PER R.C. 315.251
RS 7/1/04
OFFICE OF THE
CEAUGA COUNTY ENGINEER

GUTOSKEY & ASSOCIATES INC.
Civil Engineers and Surveyors
17078 MUNN ROAD, UNIT 3 TEL (440) 543-6900
CHAGRIN FALLS, OHIO 44023 FAX (440) 543-7176

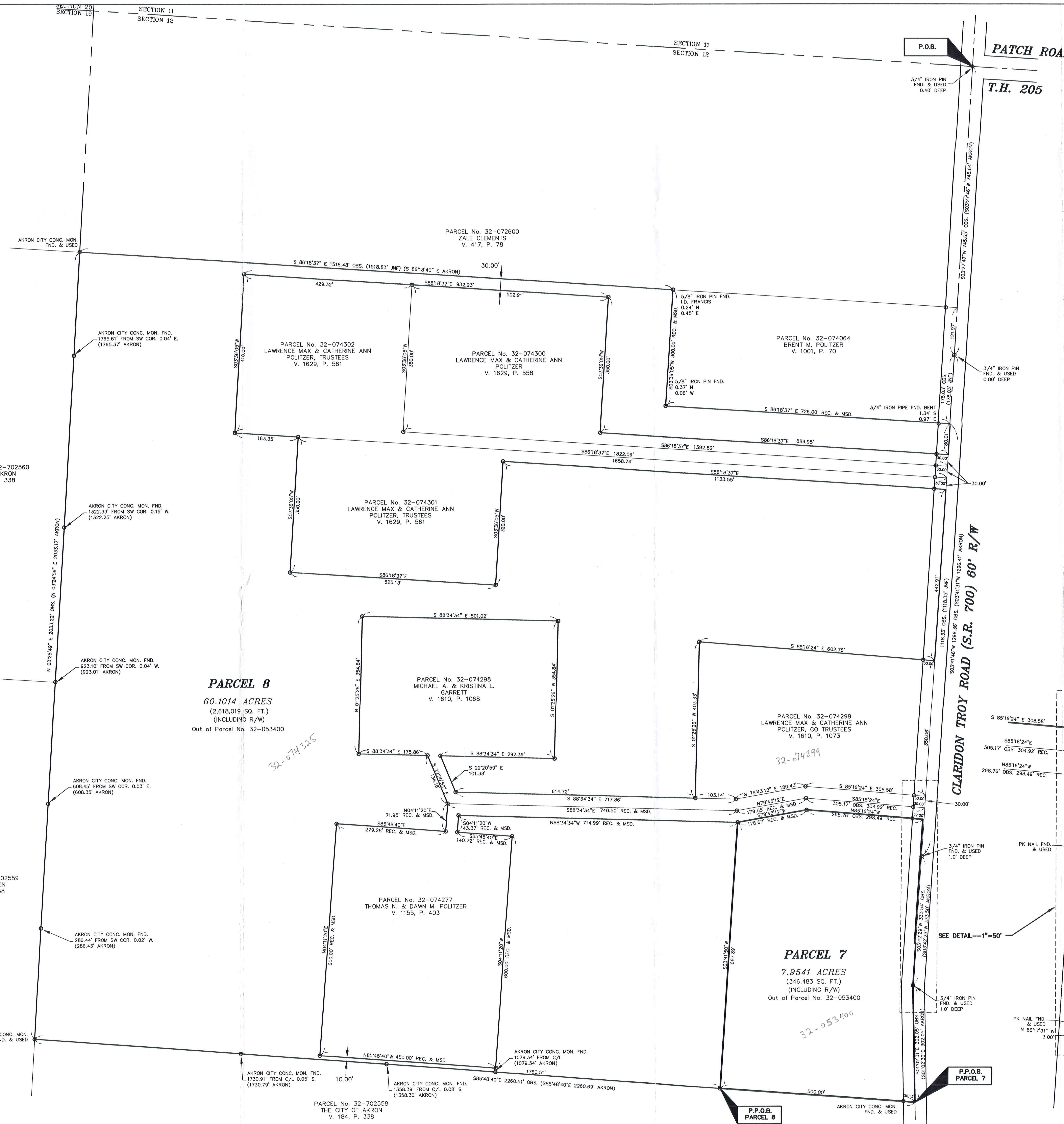

anotherlotsplit.dwg 6-10-04 9:01:09 am EST



Gutoskey & Associates, Inc.

Civil Engineers, Surveyors, & Land Planners

Joseph Gutoskey, P.E., P.S.

Legal Description Parcel 7

32-053400

Vol. 1756-Pg. 1101

7.9541 Acres

Situated in the Township of Troy, County of Geauga and State of Ohio, and known as being part of Original Section 12 within said township and is further bounded & described as follows;

Beginning at a 3/4" iron pin found (no I.D., 0.40 feet deep) on the north line of said Section 12 at the centerline intersection of Claridon Troy Road, A.K.A. S.R. 700 (60 feet wide) and Patch Road;

Thence **South 03° 27' 47" West**, along the centerline of said Claridon Troy Road, **745.65 feet** to a 3/4" iron pin found (no I.D.) at an angle point in said centerline;

Thence **South 03° 41' 46" West**, along the centerline of said Claridon Troy Road, **1296.36 feet** to a 3/4" iron pin found (no I.D., 1.0' deep) at an angle point in said centerline;

Thence **South 03° 42' 29" West**, along the centerline of said Claridon Troy Road, **333.54 feet** to a 3/4" iron pin found (no I.D., 1.0' deep) at an angle point in said centerline;

Thence **South 01° 02' 31" East**, along the centerline of said Claridon Troy Road, **302.05 feet** to a point at the northeasterly corner of land conveyed to The City of Akron by volume 184, page 338 of Geauga County Deed Records and the Principal Place of Beginning of the parcel of land herein intended to be described;

Course I Thence **North 85° 48' 40" West**, along the northerly line of said City of Akron passing over an Akron City concrete monument found at 30.13 feet, **500.00 feet** to a 3/4" iron pin set;

Course II Thence **North 03° 41' 50" East**, **687.89 feet** to a 5/8" iron pin found at a southeasterly corner of land conveyed to Thomas N. & Dawn M. Politzer by volume 1155, page 403 of Geauga County Deed Records;

Course III Thence **North 79° 43' 12" East**, along a southerly line of said Politzer, **178.67 feet** to a 5/8" iron pin found;

Course IV Thence **South 85° 16' 24" East**, along a southerly line of said Politzer, passing over a 5/8" iron pin found at 271.76 feet, **298.76 feet** to a PK nail found in asphalt;

Course V Thence **South 03° 41' 46" West**, along a westerly line of said Politzer, **95.40 feet** to a PK nail found in asphalt;

Course VI Thence **South 03° 42' 29" West**, along a westerly line of said Politzer, **224.65 feet** to a PK nail found in asphalt at a southwesterly corner of said Politzer;

6/28/2004

Course VII Thence **South 86° 17' 31" East**, along a southerly line of said Politzer, **3.00 feet** to a point on the centerline of said Claridon Troy Road and a southeasterly corner of said Politzer;

Course VIII Thence **South 03° 42' 29" West**, along said centerline, **108.89 feet** to 3/4" iron pin found (no I.D.) at an angle point in said centerline;

Course IX Thence **South 01° 02' 31" East**, along said centerline, **302.05 feet** to the Principal Place of Beginning, and containing 7.9541 Acres (346,483 square feet) of land as surveyed and described in June, 2004, by Joseph Gutoskey, P.S. 7567, be the same, more or less, but subject to all legal highways. Bearings are based on a survey by the City of Akron. All 5/8" iron pins found are stamped "Gutoskey" unless otherwise indicated.

Joseph Gutoskey P.S.
6/28/04

Deed of Record
Volume 1629, Page 561

SURVEY PLAT & LEGAL DESCRIPTION
APPROVED PER R.C. 315.251

P.S. 7/1/04

OFFICE OF THE
GEAUGA COUNTY ENGINEER

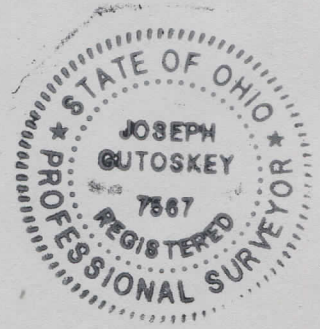

ADDS O & MHI



Gutoskey & Associates, Inc.

Civil Engineers, Surveyors, & Land Planners

Joseph Gutoskey, P.E., P.S.

Legal Description Parcel 8

60.1014 Acres

Situated in the Township of Troy, County of Geauga and State of Ohio, and known as being part of Original Section 12 within said township and is further bounded & described as follows;

Beginning at a 3/4" iron pin found (no I.D., 0.40 feet deep) on the north line of said Section 12 at the centerline intersection of Claridon Troy Road, A.K.A. S.R. 700 (60 feet wide) and Patch Road;

Thence **South 03° 27' 47" West**, along the centerline of said Claridon Troy Road, **745.65 feet** to a 3/4" iron pin found (no I.D.) at an angle point in said centerline;

Thence **South 03° 41' 46" West**, along the centerline of said Claridon Troy Road, **1296.36 feet** to a 3/4" iron pin found (no I.D., 1.0' deep) at an angle point in said centerline;

Thence **South 03° 42' 29" West**, along the centerline of said Claridon Troy Road, **333.54 feet** to a 3/4" iron pin found (no I.D., 1.0' deep) at an angle point in said centerline;

Thence **South 01° 02' 31" East**, along the centerline of said Claridon Troy Road, **302.05 feet** to a point at the northeasterly corner of land conveyed to The City of Akron (32-702558) by volume 184, page 338 of Geauga County Deed Records;

Thence **North 85° 48' 40" West**, along the northerly line of said City of Akron parcel and passing over an Akron City concrete monument found at 30.13 feet, **500.00 feet** to a 3/4" iron pin set and the Principal Place of Beginning of the parcel of land herein intended to be described;

Course I Thence, continuing **North 85° 48' 40" West**, along said northerly line and passing over Akron City's concrete monuments found at 579.34 feet, 858.39 feet (0.08 feet south), and 1230.91 feet (0.05 feet south), **1760.51 feet** to an Akron City concrete monument found on the easterly line of another parcel of land conveyed to The City of Akron (32-702559) by volume 184, page 338 of Geauga County Deed Records;

Course II Thence **North 03° 25' 49" East**, along the easterly line of said City of Akron (32-702559) passing over Akron City's concrete monuments found at 286.44 feet (0.02 feet west), 608.45 feet (0.03 feet east), 923.10 feet (0.04 feet west), 1322.33 feet (0.15 feet west), and 1765.61 feet (0.04 feet east), **2033.22 feet** to an Akron City concrete monument found at the northeasterly corner of another parcel of land conveyed to The City of Akron (32-702560) by volume 184, page 338 of Geauga County Deed Records, said point also known as being on the southerly line of land conveyed to Zale Clements by volume 417, page 78 of the Geauga County Deed Records;

Legal Description

- Course III Thence **South 86° 18' 37" East**, along the southerly line of said Zale Clements, **1518.48 feet** (witness a 5/8" iron pin found capped Francis 0.24 feet north, 0.45' east) to the northwesterly corner of land conveyed to Brent M. Politzer by volume 1001, page 70 of the Geauga County Deed Records;
- Course IV Thence **South 03° 36' 05" West**, along the westerly line of said Brent M. Politzer, **300.00 feet** (witness a 5/8" iron pin found (no I.D.) 0.37 feet north, 0.06' west) to the southwesterly corner of said Brent M. Politzer;
- Course V Thence **South 86° 18' 37" East**, along the southerly line of said Brent M. Politzer, passing the right of way line of said Claridon Troy Road (witness a 3/4" iron pipe found (no I.D.) 1.34' south, 0.97' east) at 696.00 feet, **726.00 feet** to a point on the centerline of said Claridon Troy Road, and the southeasterly corner of said Brent M. Politzer;
- Course VI Thence **South 03° 41' 46" West**, along said centerline, **80.01 feet** to a point at a northeasterly corner of land conveyed to Lawrence Max & Catherine Ann Politzer by volume 1629, page 558 of the Geauga County Deed Records;
- Course VII Thence **North 86° 18' 37" West**, along a northerly line of said Politzer, passing over a 5/8" iron pin found at 30.00 feet, **889.96 feet** to a 5/8" iron pin found;
- Course VIII Thence **North 03° 36' 05" East**, along an easterly line of said Politzer, **350.00 feet** to a 5/8" iron pin found at a northeasterly corner of said Politzer;
- Course IX Thence **North 86° 18' 37" West**, along a northerly line of said Politzer, **932.23 feet** to a 5/8" iron pin found at a northwesterly corner of land conveyed to Lawrence Max & Catherine Ann Politzer, Trustees (32-074302) by volume 1629, page 561 of the Geauga County Deed Records;
- Course X Thence **South 03° 36' 05" West**, along a westerly line of said Politzer (32-074302), **410.00 feet** to a 5/8" iron pin found at a southwesterly corner of said Politzer (32-074302);
- Course XI Thence **South 86° 18' 37" East**, along a southerly line of said Politzer (32-074302), **163.35 feet** to a 5/8" iron pin found at a northwesterly corner of land conveyed to Lawrence Max & Catherine Ann Politzer, Trustees (32-074301) by volume 1629, page 561 of the Geauga County Deed Records;
- Course XII Thence **South 03° 36' 05" West**, along a westerly line of said Politzer (32-074301), **350.00 feet** to a 5/8" iron pin found at a southwesterly corner of said Politzer (32-074301);

Legal Description

- Course XIII Thence **South 86° 18' 37" East**, along a southerly line of said Politzer (32-074301), **525.13 feet** to a 5/8" iron pin found at a southeasterly corner of said Politzer (32-074301);
- Course XIV Thence **North 03° 36' 05" East**, along an easterly line of said Politzer (32-074301), **320.00 feet** to a 5/8" iron pin found;
- Course XV Thence **South 86° 18' 37" East**, along a southerly line of said Politzer (32-074301), passing over a 5/8" iron pin found at 1103.55 feet, **1133.55 feet** to a point on the centerline of said Claridon Troy Road at a southeasterly corner of said Politzer (32-074301);
- Course XVI Thence **South 03° 41' 46" West**, along said centerline, **442.91 feet** to a point at the northeasterly corner of land conveyed to Lawrence Max & Catherine Ann Politzer, CO Trustees by volume 1610, page 1073 of the Geauga County Deed Records;
- Course XVII Thence **North 85° 16' 24" West**, along the northerly line of said Politzer, passing over a 5/8" iron pin found at 30.00 feet, **602.76 feet** to a 5/8" iron pin found at the northwesterly corner of said Politzer;
- Course XVIII Thence **South 01° 25' 26" West**, along the westerly line of said Politzer, **403.33 feet** to a 5/8" iron pin found at the southwest corner of said Politzer, said point also being on a northerly line of land conveyed to Michael A. & Kristina L. Garrett by volume 1610, page 1068 of the Geauga County Deed Records;
- Course XIX Thence **North 88° 34' 34" West**, along a northerly line of said Garrett, **614.72 feet** to a 5/8" iron pin found;
- Course XX Thence **North 22° 20' 59" West**, along a northeasterly line of said Garrett, **101.38 feet** to a 5/8" iron pin found;
- Course XXI Thence **South 88° 34' 34" East**, along a southerly line of said Garrett, **292.39 feet** to a 5/8" iron pin found at a southeasterly corner of said Garrett;
- Course XXII Thence **North 01° 25' 26" East**, along an easterly line of said Garrett, **354.84 feet** to a 5/8" iron pin found at a northeasterly corner of said Garrett;
- Course XXIII Thence **North 88° 34' 34" West**, along a northerly line of said Garrett, **501.02 feet** to a 5/8" iron pin found at a northwesterly corner of said Garrett;
- Course XXIV Thence **South 01° 25' 26" West**, along a westerly line of said Garrett, **354.84 feet** to a 5/8" iron pin found at a southwest corner of said Garrett;

Legal Description

- Course XXV Thence **South 88° 34' 34" East**, along a southerly line of said Garrett, **175.86 feet** to a 5/8" iron pin found;
- Course XXVI Thence **South 22° 20' 59" East**, along a southwesterly line of said Garrett, **134.16 feet** to a 5/8" iron pin found at a southwesterly corner of said Garrett, said point also being a northwesterly corner of land conveyed to Thomas N. & Dawn M. Politzer by volume 1155, page 403 of Geauga County Deed Records;
- Course XXVII Thence **South 04° 11' 20" West**, along a westerly line of said Politzer, **71.95 feet** to a 5/8" iron pin found;
- Course XXVIII Thence **North 85° 48' 40" West**, along a northerly line of said Politzer, **279.28 feet** to a 5/8" iron pin found at a northwesterly corner of said Politzer;
- Course XXIX Thence **South 04° 11' 20" West**, along a westerly line of said Politzer, **600.00 feet** to a 5/8" iron pin found at a southwesterly corner of said Politzer;
- Course XXX Thence **South 85° 48' 40" East**, along a southerly line of said Politzer, **450.00 feet** to a 5/8" iron pin found at a southeasterly corner of said Politzer;
- Course XXXI Thence **North 04° 11' 20" East**, along an easterly line of said Politzer, **600.00 feet** to a 5/8" iron pin found at a northeasterly corner of said Politzer;
- Course XXXII Thence **North 85° 48' 40" West**, along a northerly line of said Politzer, **140.72 feet** to a 5/8" iron pin found;
- Course XXXIII Thence **North 04° 11' 20" East**, along an easterly line of said Politzer, **43.37 feet** to a 5/8" iron pin found;
- Course XXXIV Thence **South 88° 34' 34" East**, along a southerly line of said Politzer, **714.99 feet** to a 5/8" iron pin found;
- Course XXXV Thence **South 03° 41' 50" West**, **687.89 feet** to the Principal Place of Beginning, and containing 60.1014 Acres (2,618,019 square feet) of land as surveyed and described in June, 2004, by Joseph Gutoskey, P.S. 7567, be the same, more or less, but subject to all legal highways. Bearings are based on a survey by the City of Akron. All 5/8" iron pins found are stamped "Gutoskey" unless otherwise indicated.

Deed of Record
Volume 1629, Page 561

APPROVED SURVEY PLAT & LEGAL DESCRIPTION
APPROVED PER R.C. 315.251

R.S. 711104

OFFICE OF THE
GEAUGA COUNTY ENGINEER

Joseph Gutoskey
6/20/04

